

Owner
MD Hutch Plaza 2, LLC
 c/o Simone Development
 1250 Waters Place
 Penthouse Suite 1
 Bronx, NY 10461

Architect
SBLM Architects
 151 West 26th Street, New York, NY 10001
 T: 212.995.5600 F: 212.675.4226

Structural
Severud Associates
 469 Seventh Avenue, New York, NY 10018
 T: 212.986.3700

Mechanical, Plumbing, Electrical
DI Bari Engineering, P.C.
 99 Main Street Dobbs Ferry, NY 10522
 T: 914.479.9705

Civil Engineer
Philip Habib & Associates
 102 Madison Avenue, 11th Floor, New York, NY 10016
 T: 212.929.5656

Vertical Transportation
Joseph Neto & Associates
 1065 Avenue of Americas Suite 820, New York, NY
 T: 212.596.4689

Construction Management
Gamut Consulting Inc.
 210 West Rogues Path Cold Spring Hills, NY 11743
 T: 631.673.3111

Parking Garage Precast Design
Victor O. Stango PE.
 P.O. Box 639, Chestertown, MD 21620
 T: 410.778.5080

Revisions / Issues

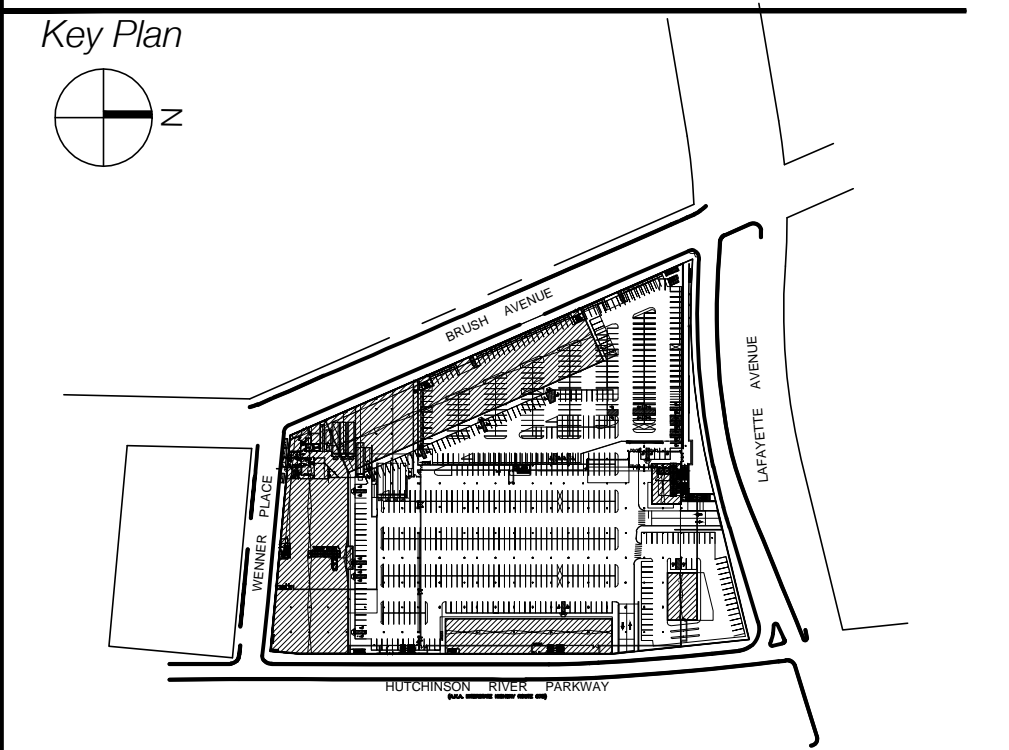

LEGEND

AVAILABLE SPACE	ENTRANCE / EXIT	MECHANICAL AREA
LEASED SPACE	SERVICE CORRIDOR	TRAFFIC LIGHT

TARGET		TJMAXX	
DESCRIPTION	AREA (sf)	DESCRIPTION	AREA (sf)
FIRST FLOOR LEASE AREA	3,163	FIRST FLOOR LEASE AREA	1,386
CELLAR LEASE AREA	165,299	CELLAR LEASE AREA	27,031
TOTAL LEASE AREA	168,462	TOTAL LEASE AREA	28,417

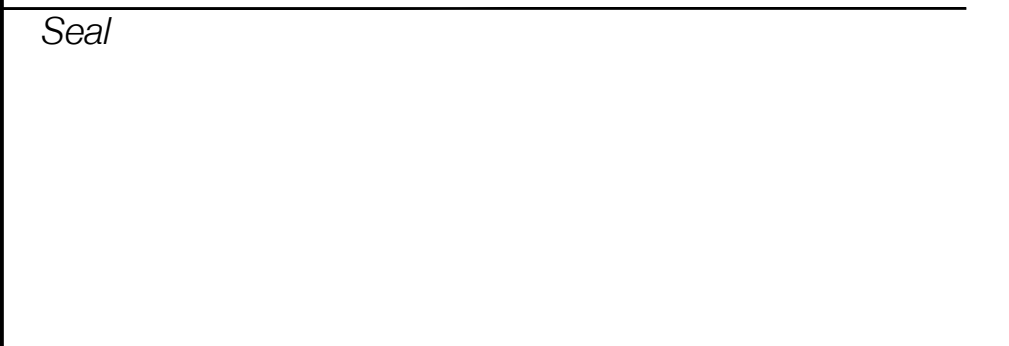
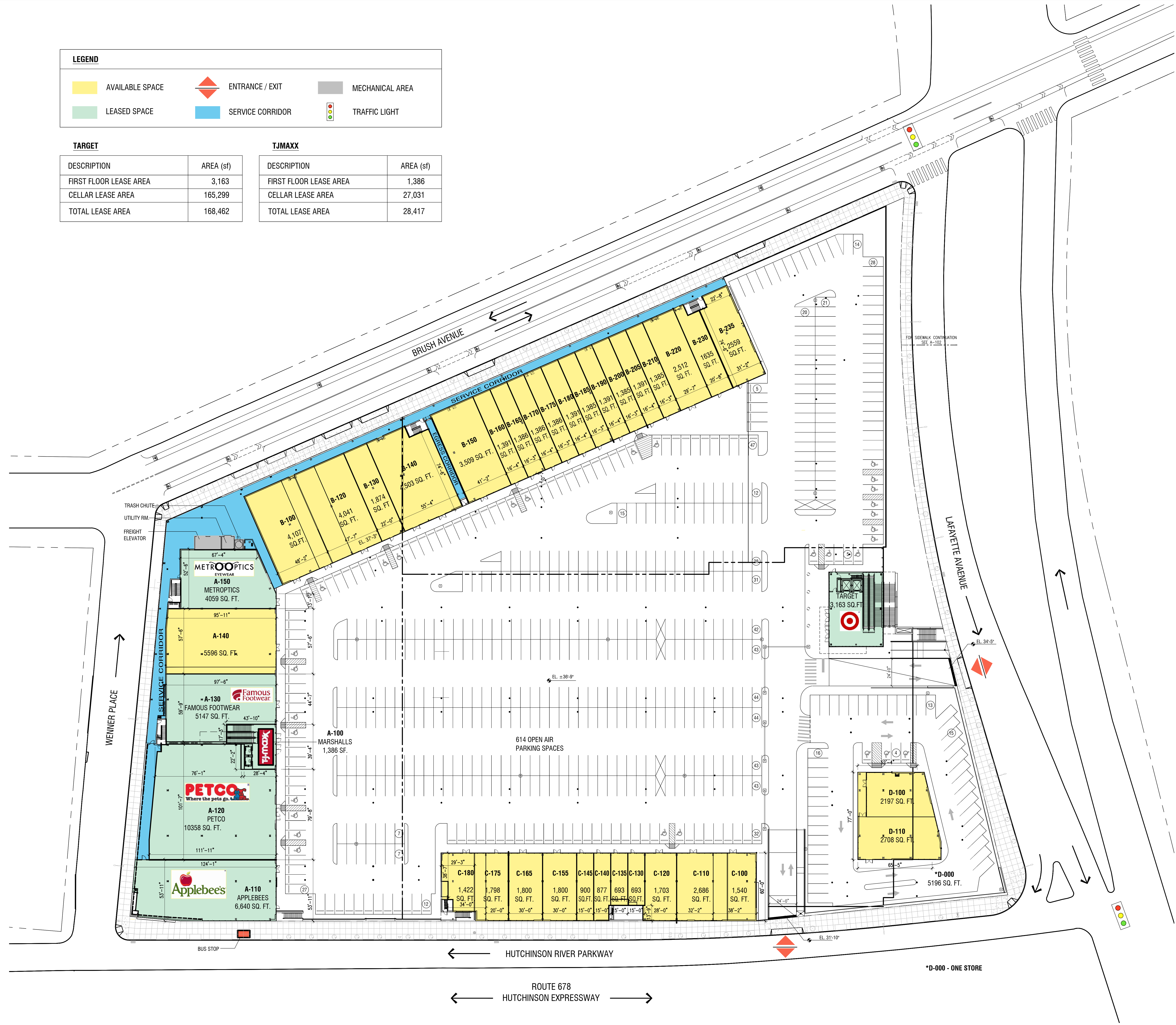

Project Information
THROGS NECK SHOPPING CENTER
 815 HUTCHINSON RIVER PARKWAY
 BRONX, NY 10465

Job Number **11110**
 Drawing Title
SITE PLAN - LEASING

Scale **1/32"=1'-0"**
 Drawing Date **06.20.12**

Drawing No.

L-100

File name: C:\PROJECT DRAWINGS\MD Hutch Plaza 2 LLO\11110 Throgs Neck Retail Center Bronx NYC\Current_SiteArch\Current_Site_Cad\Leasing Plans\11110_L-100.dwg Plotted by: Iris A. George Plot Time: 9/11/2012 12:50 PM